

# NANDINI **Pride**

2 & 3 BHK Luxury Flats

Experience a glimpse of peaceful living!



### What is life at OSNC Nandini Pride

OSNC Nandini Pride is a magnificent project coming up at Thalaghattapura, Off Kanakapura Main Road, Bangalore, offering 2 and 3 fully customised luxurious apartments that will simply inspire your senses and take your breath away. Inspired by the simplicity of mother nature and its peace, OSNC Nandini Pride will comprise of 56 exquisitely built luxury apartments.

This masterpiece is designed with a panoramic insight as it gives an extended invitation to factors such as plentiful light, ventilation, open spaces and green areas, without really compromising on the privacy element. Through a rich array of exclusive facilities and amenities, may it be a simple bird bath or a well equipped gym, OSNC Nandini Pride would make your life healthier, more relaxing and rewarding, and hence redefining your comfort and lifestyle quotient.



## Tradition of excellence

Translating the visions and dreams of future home owners into an actual timeless residence is an exciting process.

At OSNC, our experienced and caring professionals have focused on value and quality of craftsmanship.

Our team combines its expertise to design and build to match the contemporary plans and distinctive lifestyles of our clients.

OSNC now presents a master piece - OSNC Nandini Pride.  
at Thalaghattapura, Off Kanakapura Main Road, Bangalore.

# Typical floor plan







## Isometric views

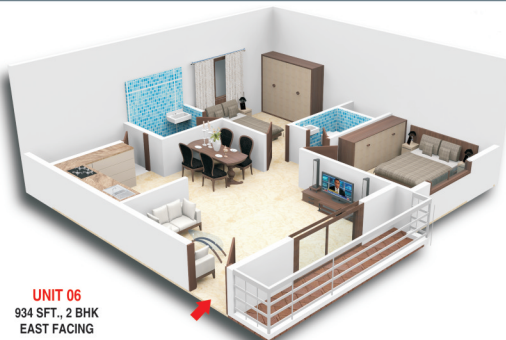



**UNIT 09**  
1293 SFT., 3 BHK  
NORTH FACING



**UNIT 10**  
1107 SFT., 2 BHK  
NORTH FACING



**UNIT 11**  
1349 SFT., 3 BHK  
NORTH FACING



**UNIT 12**  
951 SFT., 2 BHK  
NORTH FACING



I have so much more spare time, since my office is so close by.

I can go shopping anytime I want. I just have to hop over to the mall!

With all these hotels around, my outstation guests are also taken care of!

My in-laws are never bored because of all the great amenities!

I start my morning with a healthy workout at the gym!



# Specifications



## Building structure

RCC framed structure with walls designed for seismic forces and raft foundation.



## Flooring

Living, bedrooms, dining area & kitchen - Vitrified tiles.

Toilets - Antiskid tile flooring with ceramic tile dado upto door height  
Balconies - Anti skid ceramic tiles with water proofing treatment.



## External and internal paint

External wall : 1 coat of primer & 2 coats of Apex paint.

All internal walls : Emulsion paint with 2 coats of wall putty.



## Windows

3 track aluminium sliding windows which are fire proof and sound proof & have safety grills.



## Doors

**Main door :**  
Teak frame with OST shutters.

**Other doors :**  
Sal wood frame with flush shutters



## Toilets

CP fittings with Hindware make.  
Concealed piping system of Aashirwad.  
Porcelain sanitary wares of Hindware.



## Kitchen

Granite cooking platform with stainless steel sink.  
CP fittings of Hindware.



## Electricals

Concealed wiring with Anchor Roma Switches, A C, TV & Telephone points in Living and Master Bedrooms.



## Water

24 hours water supply from bore well.



## Security features

Round the clock security.  
Intercom facility with entrance gate from each apartment.



## Lifts

2 automatic lift of reputed make and 6 passenger capacity.

## Amenities



Children play area



Chess



Multi purpose hall



Gymnasium



Club House



Carrom

## Facilities

- ❖ Spacious & quality construction by reputed builders.
- ❖ Architecturally sound structure with provision for good interior
- ❖ Vaasthu compliance by reputed consultancy
- ❖ Paved pathway up to building entrance
- ❖ Loan facility arranged by leading financial banks
- ❖ Generator power backup for entire apartment
- ❖ Car parking
- ❖ Rain water harvesting



CCTV Surveillance  
in common area

# Location details



## SCHOOLS

- RMS International School - 7 Kms.
- Ekya School - 4 Km.
- Alpine Public School - 5.5 Kms.
- Delhi Public School - 8 Kms.
- Kumaran's School - 2 Kms.
- Jnana Sweekar public School - 2.5 Kms.
- Yashaswi International School - 1.7 Kms.

## COLLEGES

- PSI Technology - 500 Mts.
- KSIT - 500 mts.
- Yellamma Dasappa Institute of Technology - 1 Km.
- City Engineering College - 2 Kms.
- Dayanandasagar College - 8 Kms.
- RNSIT - 6 Kms.
- JSS Engg. College - 5 Kms.
- Jyothy Institute of Technology - 3 Kms.



## ACCESSIBILITY

- Metro Station - 3 Km.
- Majestic - 17 Kms.
- Airport - 54 Kms.



## TEMPLES

- Iskon Temple - 3.5 Kms.
- Saibaba Temple - 2.5 Kms.
- Banashankari Temple - 6.5 Kms.



## BANKS

- SBI - 2.5 Kms.
- Canara Bank ATM - 1 Km.
- Syndicate Bank - 2 Km.
- Axis Bank - 1 Kms.
- Indian Overseas Bank - 2 Kms.
- City Union Bank - 2.5 Kms.
- HDFC - 4.0 Kms.



## SHOPPING MALLS

- Shop well Mart - 600 Mts.
- Metro
- Cash & carry - 5 Kms.
- Royal Mart - 4.5 Kms.
- Sobha Mall - 1.5 Km.
- (Metro Station Attached)
- Prestige Mall - 2.5 Kms.
- (Konanakunte Metro Station attached)



## HOSPITALS

- MATHRU Multi Speciality Hospital - 2.0 Kms.
- Metro Multi Speciality Hospital - 2.5 Km.
- Sai Ram Hospital - 1.2 Kms.
- Supurva Hospital - 2.2 Kms.
- Metro Multi Speciality Hospital - 3.8 Km.
- Sagar Hospital - 4 Kms.
- Nanasina Netralaya (Eye Hospital) - 5.8 Kms.

## COMPLETED PROJECTS



NANDINI  
SUNSHINE-2



NANDINI  
PARADISE



NANDINI  
GOLDEN NEST



NANDINI SPRINGFIELD



NANDINI  
GALAXY

## ONGOING PROJECT



NANDINI TEMPLE VIEW



## Location Map



A project by :  
**OSNC Builders**  
Kodipalya, Kengeri,  
Off Mysore Road,  
Bengaluru - 560 060.  
Email : [osncbuilders@gmail.com](mailto:osncbuilders@gmail.com)

Site address  
**OSNC**  
**Nandini Pride**  
10/4, KEB Road, Thalaghattapura,  
Near Thalaghattapura Police Station,  
Bengaluru - 560 062.

Architect :



**Swan Design**  
Architect and Interior Design

Srinivasanagar, BSK 1st Stage,  
Bengaluru - 560 050.  
Call : 77955 99971 / 72049 21463  
[www.swandesignarchitects.com](http://www.swandesignarchitects.com)  
Email : [ram@swandesignarchitects.com](mailto:ram@swandesignarchitects.com)

Legal advisor:  
**Mr. S Umesh**, BA, LLB.,  
21/8, 2nd Floor,  
Vasanthapura Main Road,  
Beside Manasa Talkies,  
Kanakunte Cross,  
Bengaluru - 560 061.  
Mobile : 97393 61413

For booking / contact details :

**94481 93533**

**91084 05533**

**99163 53685**